

# Day One+

## SRX300

### IN THIS GUIDE

- Step 1: Begin | 1
- Step 2: Up and Running | 5
- Step 3: Keep Going | 9

## Step 1: Begin

### IN THIS SECTION

- Meet the SRX300 | 2
- Install the SRX300 in a Rack | 2
- Power On | 5

In this guide, we walk you through how to install the SRX300 in a rack, power it up, and deploy it on your network using the J-Web Setup wizard. We've validated these procedures using vSRX on Junos OS Release 20.4R1.

**NOTE:** Are you interested in getting hands-on experience with the topics and operations covered in this guide? Visit [Juniper Networks Virtual Labs](#) and reserve your free sandbox today! You'll find the Junos Day One Experience sandbox in the stand alone category.

## Meet the SRX300

The Juniper Networks® SRX300 Services Gateway provides next-generation security, routing, switching, and WAN connectivity in a small desktop device. The SRX300 features eight 1GbE ports, including six RJ-45 network ports, and two small form-factor pluggable (SFP) transceiver ports. It also has a USB 3.0 port (type A), and a console port (RJ-45+mini



USB)

## Install the SRX300 in a Rack

### IN THIS SECTION

- [What's in the Box? | 2](#)
- [What Else Do I Need? | 2](#)
- [Rack It | 3](#)

You can install the SRX300 on a desktop, on a wall, or in a rack. This procedure shows you how to install it in a rack.

### What's in the Box?

- SRX300 Services Gateway
- A power cord appropriate for your geographic location
- An RJ-45 cable
- A DB-9 adapter
- A USB cable

### What Else Do I Need?

To mount the SRX300 in a rack, you'll need to order a rack mount kit appropriate for your installation. If you don't have a power supply adapter tray, order the SRX300-RMK0 rack mount kit. If you already have a power supply adapter tray, order the SRX300-RMK1 rack mount kit.

The SRX300-RMK0 rack mount kit has:

- Twelve flat-head M3x5mm Phillips mounting screws
- One mounting bracket
- Power supply adapter tray and two adapter stopper brackets

The SRX300-RMK1 rack mount kit has:

- Eight flat-head M3x5mm Phillips mounting screws
- Two mounting brackets

You'll also need:

- Someone to help you do the installation
- Rack mount screws appropriate for your rack
- A number two Phillips (+) screwdriver

## Rack It

1. Review [General Safety Guidelines and Warnings](#).
2. Wrap and fasten one end of the electrostatic discharge (ESD) grounding strap around your bare wrist, and connect the other end to a site ESD point.
3. Attach the mounting bracket and power supply adapter tray to the sides of the SRX300 using the screws that came with the rack mount kit and the number two Phillips (+) screwdriver.

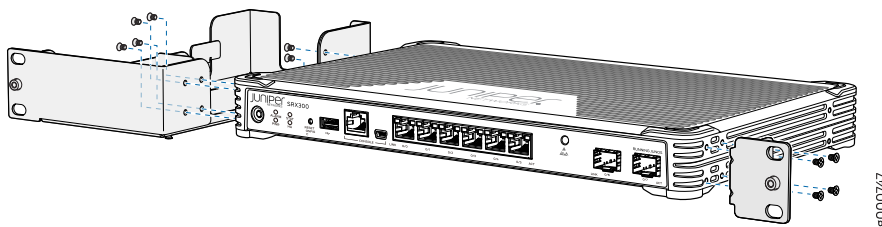

4. Place the power supply adapter in the tray.

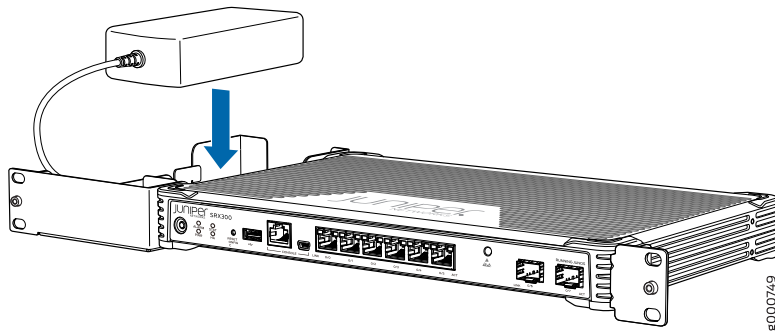

5. Lift the SRX300 and position it in the rack. Line up the bottom hole in the mounting brackets with a hole in each rack rail, making sure the SRX300 is level.

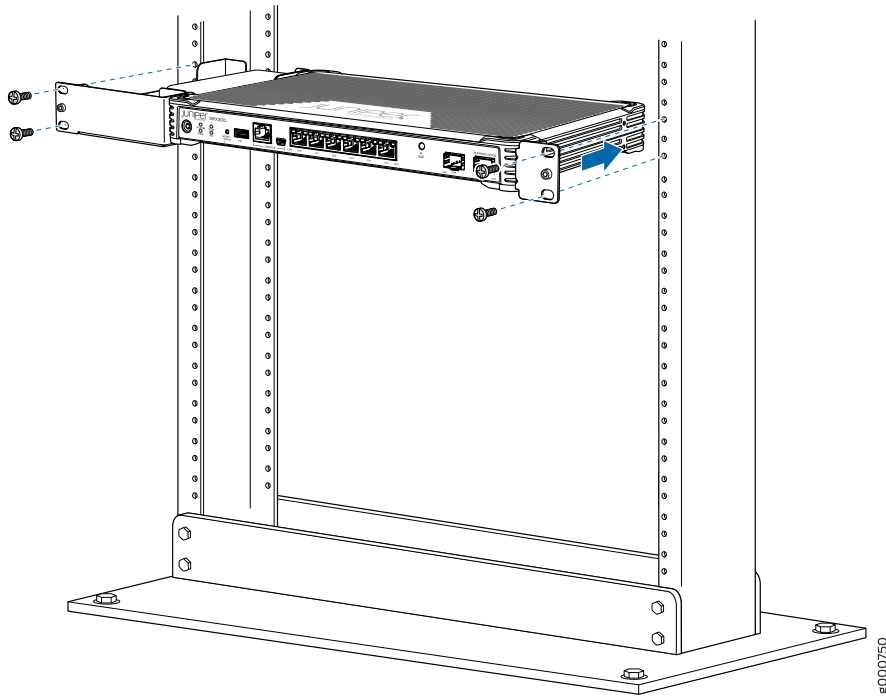

6. While you're holding the SRX300 in place, have a second person insert and tighten the rack mount screws to secure the adapter tray and mounting brackets to the rack rails. Make sure to tighten the screws in the two bottom holes first and then tighten the screws in the two top holes.
7. Check that the mounting brackets on each side of the rack are level.

## Power On

Now that you've installed your SRX300 in the rack, you're ready to connect it to power.

1. Wrap and fasten one end of the electrostatic discharge (ESD) grounding strap around your bare wrist, and connect the other end to a site ESD point.
2. Plug the DC connector end of the power cable into the power connector at the back of the SRX300.

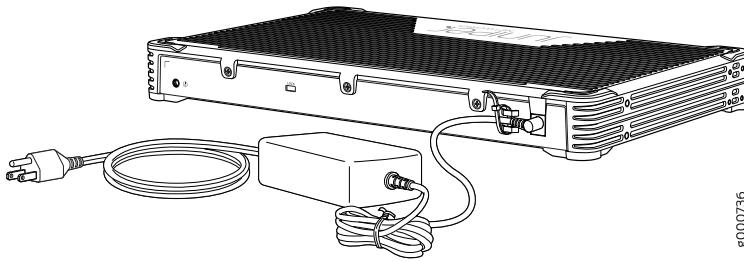

3. Plug the AC adapter end of the power cable into the power supply adapter.
4. If the AC power source outlet has a power switch, turn it off.
5. Plug in the power cord to the AC power outlet.
6. If the AC power outlet has a power switch, turn it on.

The SRX300 powers up as soon as you connect it to power. When the **STAT** LED on the front panel is lit solid green, the SRX300 is ready to use.

## Step 2: Up and Running

### IN THIS SECTION

- [Configure Root Authentication | 6](#)
- [Plug and Play | 8](#)
- [Customize the Basic Configuration with J-Web | 8](#)

Now that the SRX300 is powered on, let's do some initial configuration to get it up and running on the network. It's simple to provision and manage the SRX300 and other devices on your network. You can choose the configuration tool that's right for you:

- J-Web, Juniper Networks Setup wizard that is preinstalled on the SRX300. We'll show you how to do the initial configuration using J-Web for Junos OS Release 19.4R3. If you're using Junos OS Release 19.2 or earlier, follow the initial configuration procedure in the [SRX300 Services Gateway Hardware Guide](#).
- Juniper Sky™ Enterprise, Juniper Networks-hosted public cloud-based Software as a Service (SaaS) solution. You'll need to have a Juniper Sky Enterprise subscription service before you can use it to configure the SRX300. For more information, check out the [Juniper Sky Enterprise Getting Started Guide](#).
- Contrail Service Orchestration (CSO). To use CSO, you'll need an authentication code. See the [Contrail Service Orchestration \(CSO\) Deployment Guide](#).

If you are using Junos OS Release 19.2 or earlier, you can use Juniper Networks Network Service Controller to configure the SRX300 with ZTP. Network Service Controller is a component of CSO. See [Configure the Device Using ZTP with Juniper Networks Network Service Controller](#).

- CLI commands. See [Initial Configuration Using the CLI](#) in the SRX300 Services Gateway Hardware Guide.

## Configure Root Authentication

1. Connect any of the network ports numbered 0/1 through 0/6 to the Ethernet port on your laptop.

**NOTE:** Do not use ports 0/0 and 0/7.

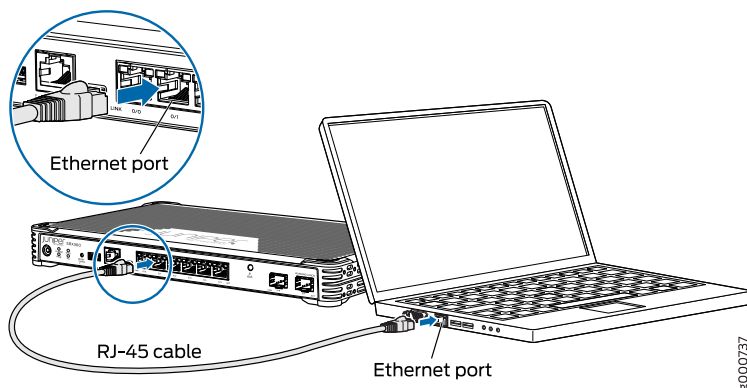

The SRX300 functions as a DHCP server and automatically assigns the laptop an IP address on the 192.168.1.0/24 network.

2. If the laptop is unable to get an IP address, manually configure an IP address in the 192.168.1.0/24 network.

Be sure you don't assign the IP address 192.168.1.1 to the laptop, because this is the IP address assigned to the SRX300.

### 3. Set the root authentication password:

- Open a browser and type **https://192.168.1.1**. You don't need to log in. The J-Web Setup wizard opens on your screen.

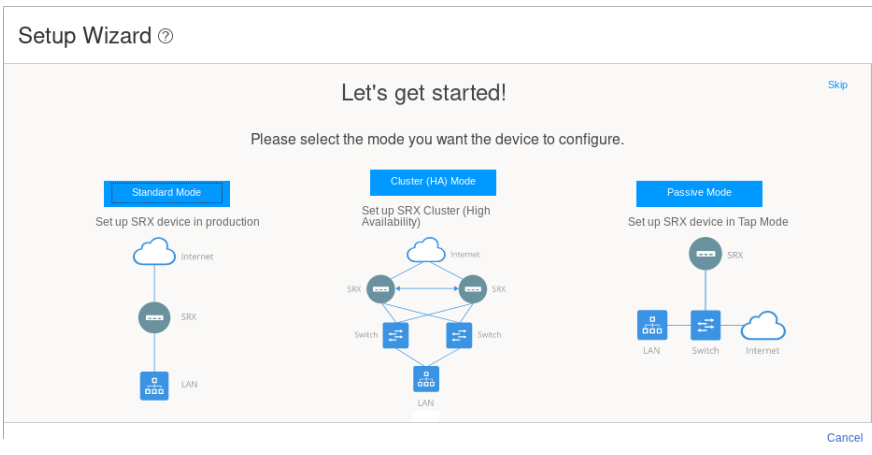

- Click **Skip** at the upper-right corner of the Setup wizard. The Device Password page appears.

- Type a root authentication password and click **OK**. The J-Web login page appears.

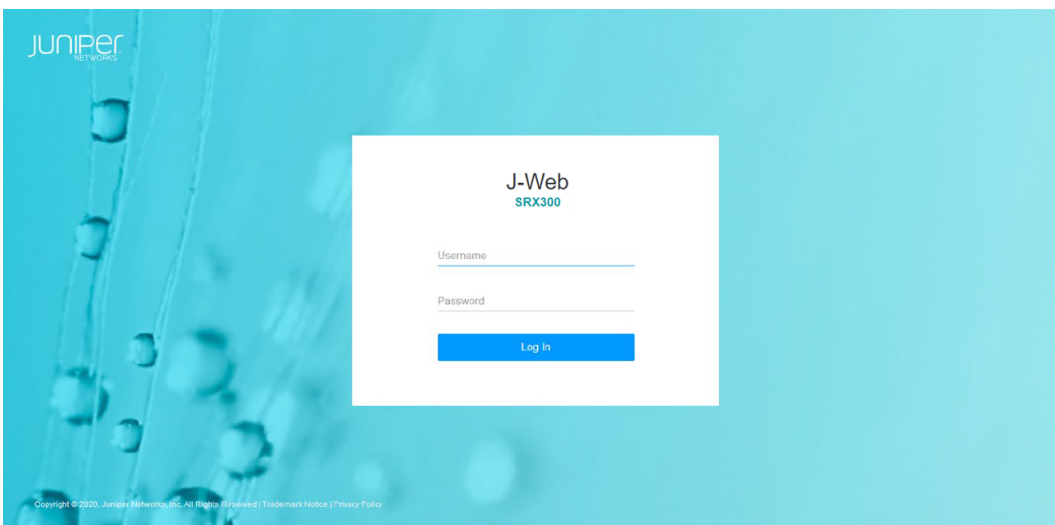

## Plug and Play

The SRX300 already has factory-default settings configured right out of the box to make it a plug-and-play device. So all you have to do to get the SRX300 up and running is connect it to your LAN and WAN. Here's how:

1. Connect the WAN network to port 0/0.
2. Connect the LAN network to any of the ports from 0/1 through port 0/6.
3. Check to see if the SRX300 is connected to the Internet. Go to <http://www.juniper.net>. If the page doesn't load, check the Internet connection.

After you complete these steps, you can start using the SRX300 on your network right away. You can go back and customize settings at any time. The J-Web Setup wizard is always available to you.

## Customize the Basic Configuration with J-Web

Have this information handy before you begin customizing the settings for your network:

- Hostname
- IP address for the NTP server
- IP address for the DNS server
- IP address for the management interface

Log in to J-Web and select Configure > Setup Wizard to launch the Setup wizard. Select the configuration mode that's right for you. You can then follow the screens as they appear in the Setup wizard.

- Standard—Configure basic security settings for the SRX300.
- Cluster (HA)—Set up the SRX300 in chassis cluster mode.
- Passive—Set up the SRX300 in Tap mode. Tap mode enables the SRX300 to passively monitor traffic flows across a network.



## Step 3: Keep Going

### IN THIS SECTION

- [What's Next? | 9](#)
- [General Information | 10](#)
- [Learn With Videos | 10](#)

Congratulations! Your SRX300 is configured and ready to go. Here are some things you can do next.

### What's Next?

If you want to	Do this
Change configuration settings, get another device up and running, or both	Log in to J-Web and use the wizard. Alternatively, you can use the more advanced configuration features offered by Juniper Contrail Service Orchestration (CSO) and Juniper Sky Enterprise. To use these services, you'll need an account and activation code. Check out the <a href="#">Contrail Service Orchestration (CSO ) Deployment Guide</a> and the <a href="#">Juniper Sky Enterprise Getting Started Guide</a> .
Set up your SRX300 with advanced security measures to protect and defend your network	Visit <a href="#">Day One: SRX Series Up and Running With Advanced Security Services</a>
Manage software upgrades on your SRX300	See <a href="#">Installing Software on SRX Series Devices</a>
See, automate, and protect your network with Juniper Security	Visit the <a href="#">Security Design Center</a>
Get hands-on experience with the procedures covered in this guide	Visit <a href="#">Juniper Networks Virtual Labs</a> and reserve your free sandbox. You'll find the Junos Day One Experience sandbox in the stand alone category.

## General Information

If you want to	Do this
Download, activate, and manage your software licenses to unlock additional features for your SRX services gateway	See <a href="#">Activate Junos OS Licenses</a> in the <a href="#">Juniper Licensing Guide</a>
See all documentation available for the SRX300	Visit the <a href="#">SRX300 Documentation</a> page in the Juniper TechLibrary
Configure the SRX300 with the Junos OS CLI	Start with the <a href="#">Day One+ for Junos OS</a> guide
Configure the SRX300 using J-Web	See <a href="#">J-Web for SRX Series Documentation</a>
Stay up-to-date on new and changed features and known and resolved issues.	See <a href="#">Junos OS Release Notes</a>

## Learn With Videos

Our video library continues to grow! We've created many, many videos that demonstrate how to do everything from install your hardware to configure advanced Junos OS network features. Here are some great video and training resources that will help you expand your knowledge of Junos OS.

If you want to	Then
View a Web-based training video which provides an overview of the SRX300 and describes how to install and configure it	<a href="#">SRX300 and SRX320 Services Gateways Overview and Deployment (WBT)</a>
Get short and concise tips and instructions that provide quick answers, clarity, and insight into specific features and functions of Juniper technologies	See <a href="#">Learning with Juniper</a> on Juniper Networks main YouTube page
View a list of the many free technical trainings we offer at Juniper	Visit the <a href="#">Getting Started</a> page on the Juniper Learning Portal

Juniper Networks, the Juniper Networks logo, Juniper, and Junos are registered trademarks of Juniper Networks, Inc. in the United States and other countries. All other trademarks, service marks, registered marks, or registered service marks are the property of their respective owners. Juniper Networks assumes no responsibility for any inaccuracies in this document. Juniper Networks reserves the right to change, modify, transfer, or otherwise revise this publication without notice. Copyright © 2021 Juniper Networks, Inc. All rights reserved. Rev. 07, September 2021.