

Chapter 3

Installing and Setting Up JUNOScope Software for AIS

This chapter provides references on how to install and set up the JUNOScope 9.0 or later software to integrate with Advanced Insight Manager (AIM) to:

- Import devices managed by JUNOScope
- Automatically install AI-Script to multiple devices at once

Figure 8 shows the sequence to install and set up the JUNOScope software.

Figure 8: Automatic AI-Script Install Package Installation Using JUNOScope Script Management

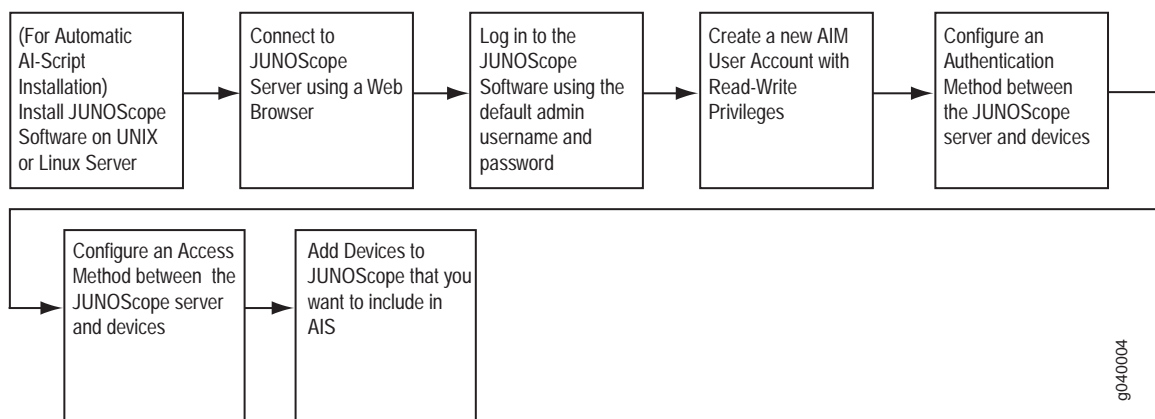

Install the JUNOScope software on the same server as the Advanced Insight Manager (AIM) application. However, install JUNOScope software first.

This chapter includes the following sections

- Installing the JUNOScope Software on page 20)
- Connecting to the JUNOScope Software on page 20
- Logging In to the JUNOScope Software on page 20)
- Adding an AIM User with Read-Write Privileges on page 20)

- Set Up an Authorization Method on page 20)
- Set Up an Access Method on page 21)
- Adding Devices on page 21)

Installing the JUNOScope Software

To install JUNOScope 9.0 Software or later, see the *JUNOScope Software User Guide*, Installing, Reconfiguring, Reinstalling, Upgrading, or Uninstalling the JUNOScope Software chapter. You can view the *JUNOScope Software User Guide* at www.juniper.net/techpubs/.

Connecting to the JUNOScope Software

After you have installed the JUNOScope software, connect to it using a supported Web browser, including Microsoft Internet Explorer 6 or Netscape Navigator 6 or later with JavaScript enabled. See the *JUNOScope Software User Guide*, Installing, Reconfiguring, Reinstalling, Upgrading, or Uninstalling the JUNOScope Software chapter, “Connecting to the JUNOScope Software from a Client Workstation and Logging In” section.

Logging In to the JUNOScope Software

Log into the JUNOScope software using the valid JUNOScope user name and login password. The username and password are the ones specified during installation. See the *JUNOScope Software User Guide*, Installing, Reconfiguring, Reinstalling, Upgrading, or Uninstalling the JUNOScope Software chapter, “Connecting to the JUNOScope Software from a Client Workstation and Logging In” section.

Adding an AIM User with Read-Write Privileges

Create an AIM user in JUNOScope with read-write privileges. You need to remember the AIM user name and password for AIM setup. (See *JUNOScope Software User Guide*, Setting Up User Local Authentication chapter.)

Set Up an Authorization Method

Setup an Authorization Method in the JUNOScope software for the devices you want to add.

You can specify the authentication information (login and password for accessing a router) configured on a router for remotely connecting to that router from the JUNOScope software. The JUNOScope software supports secure sockets layer (SSL) and clear-text access protocols. We recommend that you set up authentication information and access methods before you set up routers. (See *JUNOScope 9.0 Software User Guide*, Setting Up Authentication Information chapter.)

Set Up an Access Method

Setup an Access Method in the JUNOScope software for the devices you want to add.

You can specify the access method (JUNOScript access protocol to connect to the JUNOScript server running on a router) configured on a router for remotely connecting to that router from the JUNOScope software. The JUNOScope software supports secure sockets layer (SSL) and clear-text access protocols. We recommend that you set up access methods before you set up devices. See *JUNOScope Software User Guide*, Setting Up Access Methods chapter.

Adding Devices

Add devices in the JUNOScope software that you want to participate in AIS. The JUNOScope software currently supports J-series, M-series, MX-series, and T-series devices.

See *JUNOScope Software User Guide*, Setting Up Devices chapter.

You can import devices managed by the JUNOScope software into the AIM software for automatic AI-Script install package installation.

Where To Go From Here?

- Install the AIM application. See “Installing Advanced Insight Manager” on page 23

