

Secure Access 6000 Field-Replaceable Units Removal and Installation

Part No:
093-1691-000 Rev. B

This guide contains information about removing and installing field-replaceable units in the Secure Access 6000 chassis. For Secure Access 6000 safety information, refer to the *Juniper Networks Security Products Safety Guide* available on the Juniper Networks Support site. The following sections provide detailed procedures about component removal and installation:

- “Hard Disks” on page 2
- “Power Supplies” on page 3
- “Cooling Fans” on page 4

Chassis and component upgrades performed at a licensed Juniper Networks vendor are not covered in this guide.

You can find a translated version of this document at the site listed below.

以下の Web サイトでこの文書の翻訳版を入手することができます。
您可以在下列各網站找到本文件的翻譯版本。
您可以在下面所列的站点中找到本文档的翻译版本。

아래에 제시된 사이트에서 본 문서의 번역본을 찾으실 수 있습니다.

Sie finden eine übersetzte Version dieses Dokuments an der unten aufgelisteten Adresse.

Vous trouverez une version traduite de ce document sur le site de la liste ci-dessous.

Puede encontrar una versión traducida de este documento en el sitio que se indica a continuación.

<https://www.juniper.net/customers/csc/documentation/techdocs/ive/index.jsp>

Figure 1: Secure Access 6000 front and rear panels

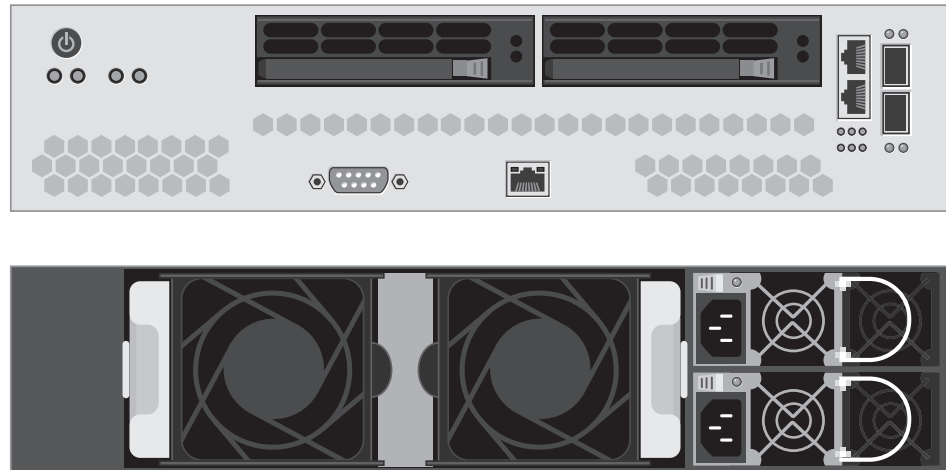

Hard Disks

The SA 6000 ships with one standard hard disk. You can, however, add an optional second hard disk to the SA 6000 chassis to offer component redundancy and help minimize IVE down time. When you install a second (redundant) hard disk, the additional hard disk maintains an exact copy of the software image and configuration information on the working hard disk. Therefore, if the working hard disk fails, the redundant hard disk immediately assumes responsibility for all IVE operations. This function is referred to as the Redundant Array of Independent Disks (RAID) mirroring process.



NOTE: The SA 6000 hard disk modules are hot-swappable. You must ensure that the IVE has booted completely and is operating correctly before removing, replacing, or upgrading a hard disk module. Once a new hard disk module is inserted, you must wait until the RAID mirroring process has completed—approximately 40 minutes—before rebooting or turning off the IVE.

Figure 2: Secure Access 6000 hard disk module

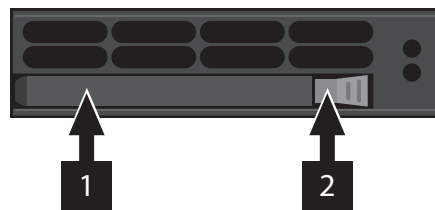

Removing an SA 6000 Hard Disk

To remove an SA 6000 hard disk:

1. On the SA 6000 hard disk module, press the handle release trigger (item 2 in Figure 2) in and to the right to release the insertion and removal handle (item 1 in Figure 2).

2. Grasp the handle and pull the hard disk module straight out of the SA 6000 chassis.
3. Once you have removed the SA 6000 hard disk module, be sure to replace it with a replacement hard disk or the “dummy” hard disk port cover installed in your SA 6000 chassis at the time of shipping.

Installing an SA 6000 Hard Disk

To install an SA 6000 hard disk:

1. With the insertion and removal handle on the SA 6000 hard disk module (item 1 in Figure 2) in the released/out position, line the hard disk module up with an empty hard disk port on the front of the SA 6000 chassis.
2. Carefully and steadily slide the hard disk module straight into the SA 6000 chassis until it is flush with the front panel of the SA 6000.

The hard disk module is properly seated in the chassis when you hear the hard disk module handle release trigger (item 2 in Figure 2) “click” into place.

3. Retract the hard disk module insertion and removal handle back into the module by swinging it back across the face of the hard disk until it is completely flush with the face of the hard disk module.

Power Supplies

The SA 6000 ships with one 500-watt AC power supply installed in the back of the chassis. You can add an optional second power supply to support redundancy and load-sharing features. In addition, if you need to replace one of the power supplies, you can “swap” the faulty power supply for a replacement while the optional second power supply assumes responsibility for the entire power load, thus avoiding a situation where you have to power off the IVE before replacing the removable unit.

Figure 3: Secure Access 6000 power supply module

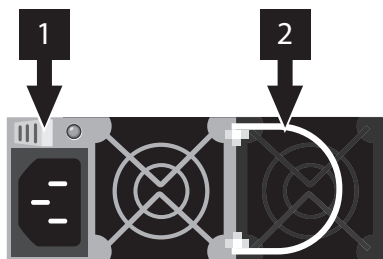

Removing an SA 6000 Power Supply

To remove an SA 6000 power supply:

1. On the SA 6000 power supply module, swing the insertion and removal handle (item 2 in Figure 3) out to a released/out position.

2. Press the release trigger (item 1 in Figure 3) to the left as you grasp the insertion and removal handle and pull the power supply module straight out of the SA 6000 chassis.
3. Once you have removed the SA 6000 power supply module, be sure to replace it with a replacement power supply or the “dummy” power supply port cover installed in your SA 6000 chassis at the time of shipping.

Installing an SA 6000 Power Supply

To install an SA 6000 power supply:

1. Line the SA 6000 power supply module up with an empty power supply port on the back of the SA 6000 chassis.
2. Carefully and steadily slide the power supply module straight into the SA 6000 chassis until it is flush with the rear panel of the SA 6000.

The power supply module is properly seated in the chassis when you hear the power supply module release trigger (item 1 in Figure 3) “click” into place.

3. If you have not done so already, retract the power supply module insertion and removal handle back into the module by swinging it back across the face of the power supply until it is completely flush with the face of the power supply module.

Cooling Fans

The SA 6000 ships with two cooling fans installed in the back of the chassis. If you need to replace one of the cooling fans, you can “swap” the faulty fan for a replacement during operation in a matter of moments. You can purchase additional cooling fans from your vendor when you order your SA 6000, or you can purchase them in the future to replace faulty or failed cooling fans, as necessary.

Figure 4: Secure Access 6000 cooling fan module

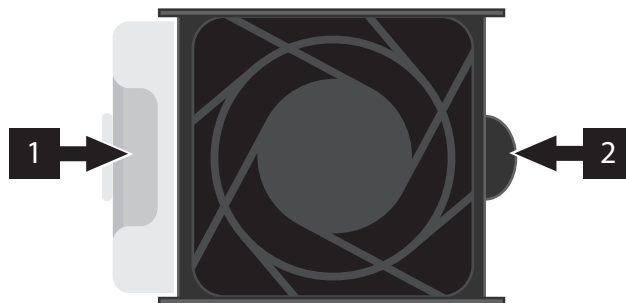

Removing an SA 6000 Cooling Fan

To remove an SA 6000 cooling fan:

1. On the SA 6000 cooling fan module, unseat the cooling fan module by pressing the release trigger (item 1 in Figure 4) sideways toward the center of the cooling fan module.

2. Grasp the cooling fan module and carefully pull it away from the rear of the chassis.



NOTE: Once you have removed the SA 6000 cooling fan module, be sure to replace it with a replacement cooling fan to ensure maximized air flow across the SA 6000's internal components.

Installing an SA 6000 Cooling Fan

To install an SA 6000 cooling fan:

1. Line the SA 6000 cooling fan module up with an empty cooling fan port on the back of the SA 6000 chassis.
2. Carefully insert the rear corner of the cooling fan module into the cooling fan port in the rear of the SA 6000 chassis so that the cooling fan module insertion tab (item 2 in Figure 4) lines up with its respective slot.
3. Carefully slide the other side of the cooling fan module into the cooling fan port until the face of the cooling fan is flush with the rear panel of the SA 6000 chassis.

The cooling fan module is properly seated in the chassis when you hear the cooling fan module release trigger (item 1 in Figure 4) “click” into place.

Copyright © 2005, Juniper Networks, Inc. All rights reserved. Juniper Networks is registered in the U.S. Patent and Trademark Office and in other countries as a trademark of Juniper Networks, Inc. ERX, ESP, E-series, Internet Processor, J-Protect, JUNOS, JUNOScript, JUNOSe, M5, M7i, M10, M10i, M20, M40, M40e, M160, M-series, NMC-RX, SDX, T320, T640, and T-series are trademarks of Juniper Networks, Inc. All other trademarks, service marks, registered trademarks, or registered service marks are the property of their respective owners. All specifications are subject to change without notice.

Juniper Networks assumes no responsibility for any inaccuracies in this document. Juniper Networks reserves the right to change, modify, transfer, or otherwise revise this publication without notice.